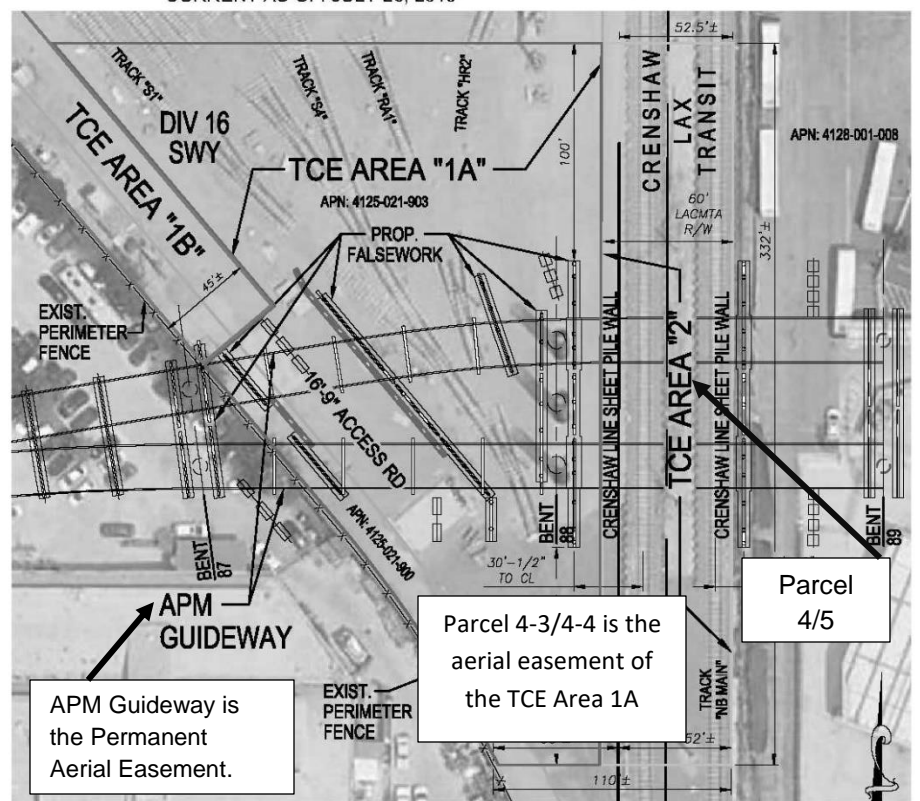
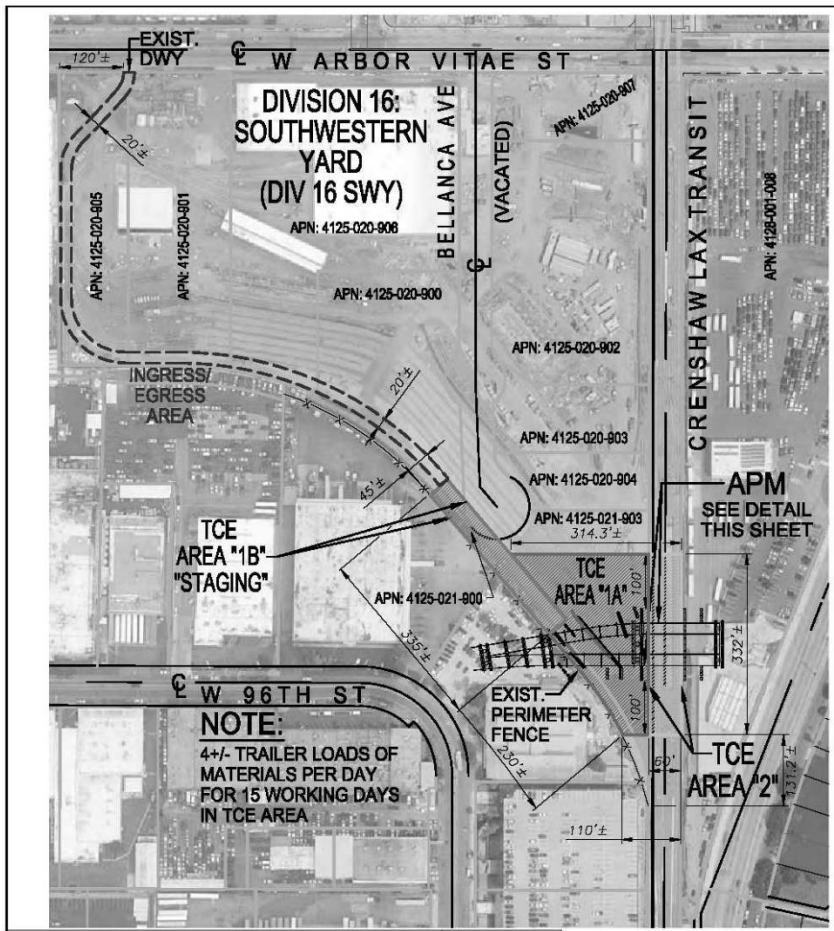

EXHIBIT A - SITE PLAN

APM FALSEWORK WITHIN AMC STATION

APN: 4125-020-900, 902, 907 / 4125-021-900, 903 / 4125-026-900
CURRENT AS OF: JULY 26, 2019



DESIRED AREAS	AREA (SF)
INGRESS/EGRESS AREA	25,640
TEMPORARY CONSTRUCTION EASEMENT AREA "1A"	49,580
TEMPORARY CONSTRUCTION EASEMENT AREA "1B" "STAGING"	14,500
TEMPORARY CONSTRUCTION EASEMENT AREA "2"	19,920

LEGEND

- EXISTING STREET CENTERLINE
- EXISTING CITY R/W
- PROPERTY LINE
- PROPOSED FALSEWORK
- PROPOSED BENTS
- LIMITS OF GUIDEWAY
- LIMITS OF TCE AREA "1A"
- LIMITS OF TCE AREA "1B"
- LIMITS OF TCE AREA "2"
- LIMITS OF INGRESS/EGRESS AREA

NOT TO SCALE