

# ATTACHMENT D - Proposed Easement Map

## HISTORICAL MONUMENTS:

- ◆ = MONUMENT IN MEMORY OF THE GABRIELENO MISSION INDIANS THAT INHABITED THE PUEBLO OF LOS ANGELES. DEDICATED ON DECEMBER 20, 1998.
- ◆ = MONUMENT HONORING THE LIVES LOST ON JUNE 24, 1971, IN A TUNNEL EXPLOSION TAKING SEVENTEEN LIVES, ONE METROPOLITAN EMPLOYEE AND SIXTEEN EMPLOYEES FROM LOCKHEED.
- ◆ = A BRICK LINE DEPICTING THE OLD CHINATOWN BOUNDARY FROM 1887.

## MWD CONTROL POINTS:

- 23859 LEAD AND TAG, STAMPED "LS 5113", FLUSH IN CONCRETE, PER R.S.B. 166/041 AND JOB NUMBER 98-350.  
N= 1842570.49  
E= 6490032.59
- 23868 1-1/2" IRON PIPE WITH TAG IN CONCRETE, STAMPED "LS 5113", IN DIRT, PER R.S.B. 166/041 AND JOB NUMBER 98-350.  
N= 1842686.40  
E= 6490053.46

## NOTES:

1. THIS MAP REPRESENTS DATA OBTAINED FROM A FIELD SURVEY PERFORMED BY MWD PERSONNEL IN JULY 2020, USING 3D SCAN SURVEYING METHODS, MWD SURVEY JOB NUMBER 20-095, MWDFB 2601-01/105-108.
2. HORIZONTAL CONTROL FOR THIS TOPOGRAPHIC MAP IS BASED UPON THE CALIFORNIA COORDINATE SYSTEM, NAD83 ZONE 5 (1991.35 EPOCH), MWD SURVEY JOB NUMBER 98-350.

## LEGEND:

- OH — CANOPY / OVERHANG
- X — EXISTING GATE
- P — PROPERTY LINE
- PROPOSED EASEMENTS
- X — PROPOSED SECURITY GATE & COURTYARD CLOSURE
- /// BUILDING / STRUCTURE
- LANDSCAPED AREA
- DOOR / GATE
- SMH SEWER MANHOLE

## ACQUISITION AREA:

- ① CONSTRUCTION = +/- 230 SQ. FT.
  - ② CONSTRUCTION = +/- 20 SQ. FT.
  - ③ CONSTRUCTION = +/- 11 SQ. FT.
  - ④ CONSTRUCTION = +/- 11 SQ. FT.
  - ⑤ CONSTRUCTION = +/- 25 SQ. FT.
  - ⑥ CONSTRUCTION = +/- 11 SQ. FT.
  - ⑦ CONSTRUCTION = +/- 379 SQ. FT.
  - ⑧ CONSTRUCTION = +/- 461 SQ. FT.
- TOTAL = +/- 1,148 SQ. FT.

## GATE ACCESS:

- Ⓐ = ENTRY AND EXIT ACCESS POINT WITH SECURITY GUARD.
- Ⓑ = EXIT ONLY ACCESS POINT
- Ⓒ = EXIT ONLY ACCESS POINT
- Ⓓ = AFTER HOURS ACCESS POINT

NOTE: ALL ACCESS POINTS WILL BE LOCKED BETWEEN 11 A.M. AND 2 P.M. DAILY, AND AFTER BUSINESS HOURS.

## DETAIL OF PROPOSED EASEMENTS

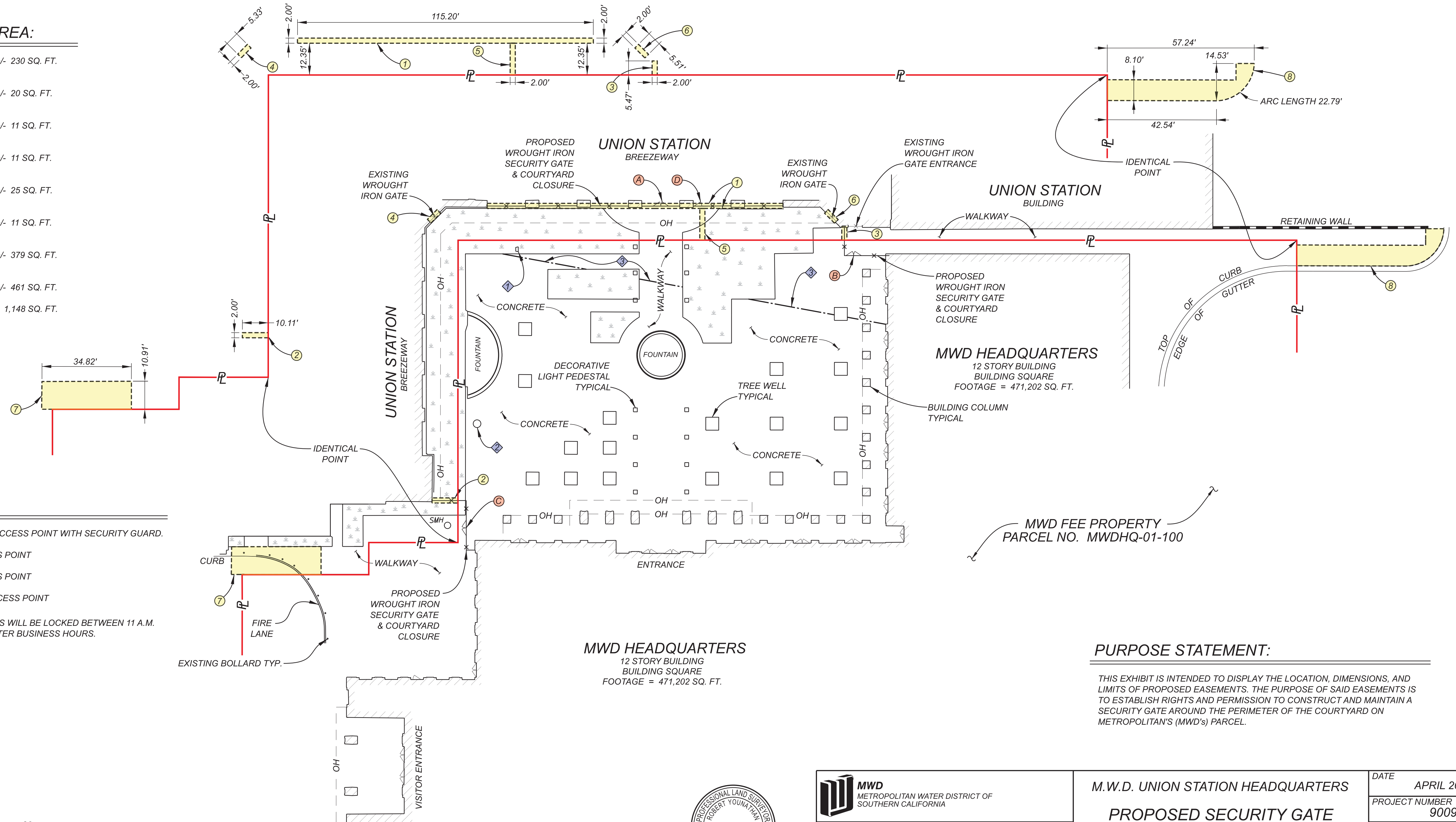

## PURPOSE STATEMENT:

THIS EXHIBIT IS INTENDED TO DISPLAY THE LOCATION, DIMENSIONS, AND LIMITS OF PROPOSED EASEMENTS. THE PURPOSE OF SAID EASEMENTS IS TO ESTABLISH RIGHTS AND PERMISSION TO CONSTRUCT AND MAINTAIN A SECURITY GATE AROUND THE PERIMETER OF THE COURTYARD ON METROPOLITAN'S (MWD'S) PARCEL.

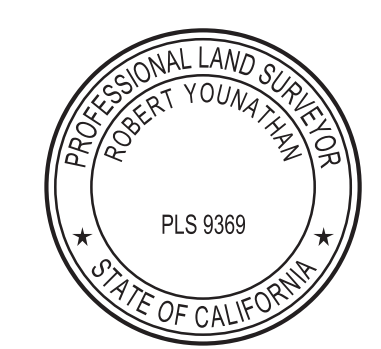
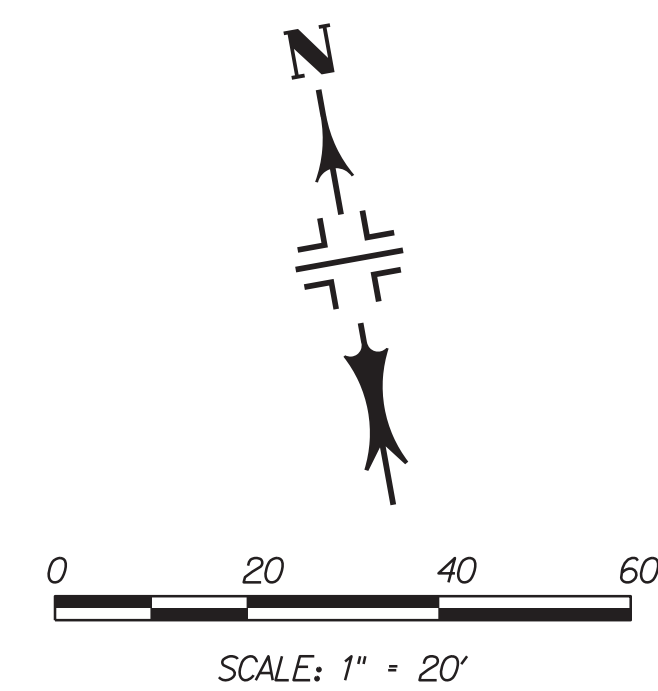

<b>MWD</b> METROPOLITAN WATER DISTRICT OF SOUTHERN CALIFORNIA		
SURVEYED	VERTICAL DATUM	SURVEY JOB NUMBER
MS, EM	N/A	20-111
DRAWN	HORIZONTAL DATUM (EPOCH)	CCS ZONE
RDY	NAD83 (1991.35)	5
CHECKED	LATITUDE	LONGITUDE
NDE	34.055411	-118.236214

M.W.D. UNION STATION HEADQUARTERS	
PROPOSED SECURITY GATE IMPROVEMENTS	
EXHIBIT MAP	

DATE	APRIL 2021
PROJECT NUMBER	900986
SHEET	1 OF 1
DWG	B-171000
REV	6