

ATTACHMENT A - AREA SITE MAPS
EXHIBIT 1 - DIVISION 7 MAP

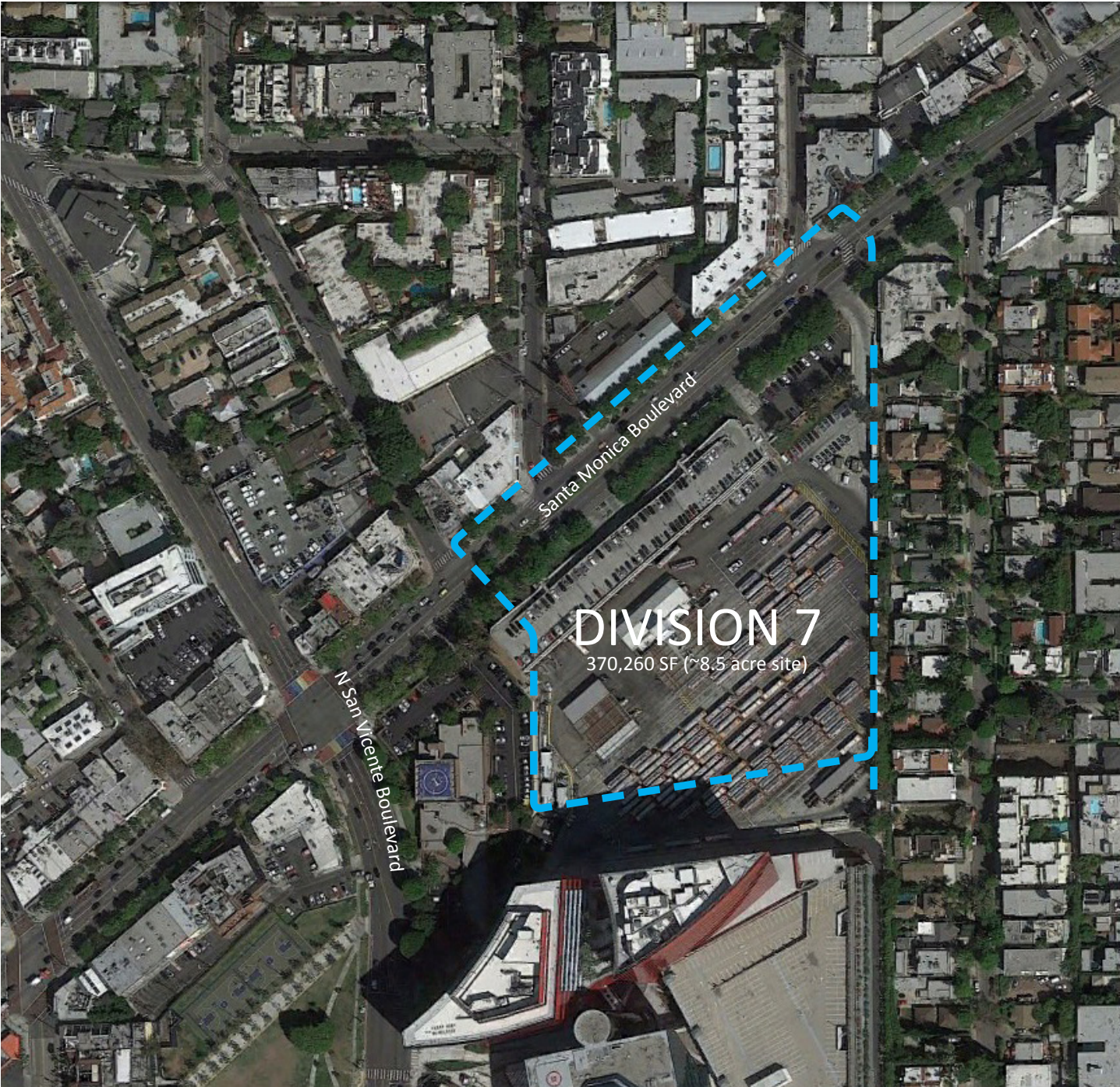
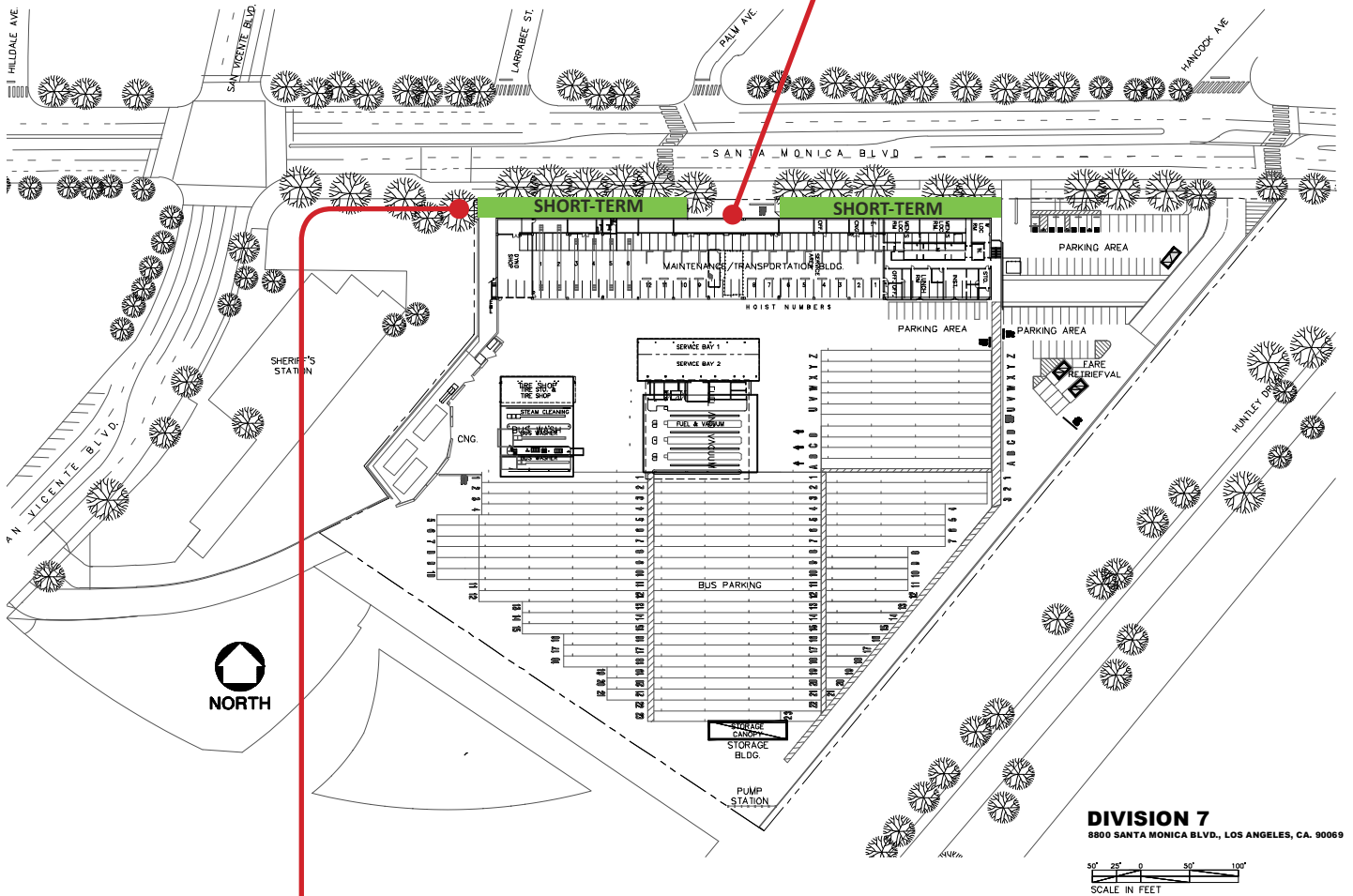

EXHIBIT 2 - PARCEL A

EXISTING DIVISION 7 BUILDING

- 24' tall at Santa Monica Boulevard
- 36' tall at bus yard
- ±80' long and ±500' wide
- Built in 1976



SHORT-TERM OPPORTUNITY

Activate the 20' setback from the back of the sidewalk to the (e) building edge.

EXHIBIT 3 - PARCEL B

EXISTING DIVISION 7 BUILDING

- 24' tall at Santa Monica Boulevard
- 36' tall at bus yard
- ±80' long and ±500' wide
- Built in 1976

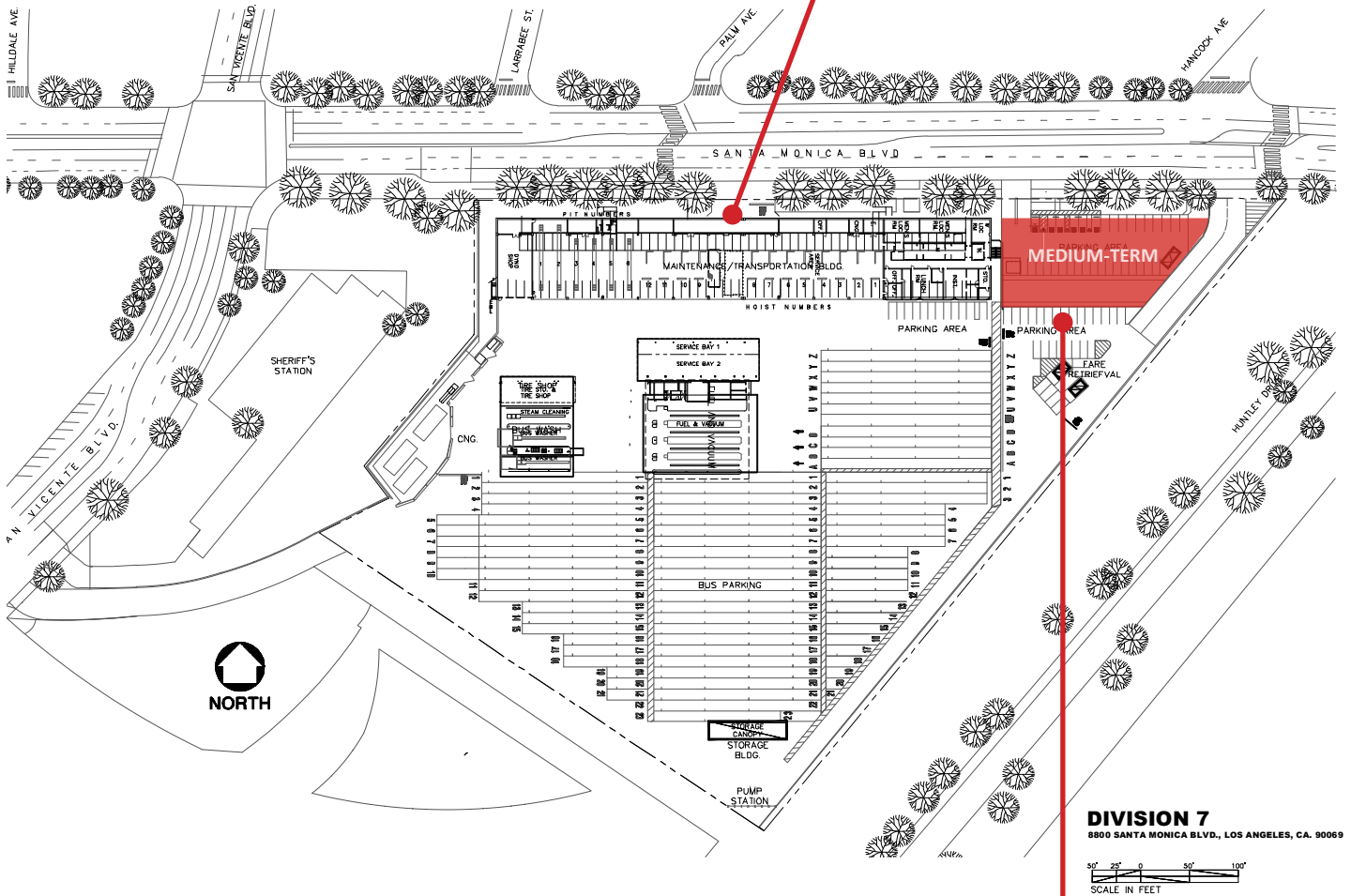

DIVISION 7
8800 SANTA MONICA BLVD., LOS ANGELES, CA. 90069

0 50' 100'
SCALE IN FEET

MEDIUM-TERM OPPORTUNITY
Activate the parking lot at the eastern edge of the site.