



HEARING TO ADOPT RESOLUTION OF NECESSITY

WESTSIDE PURPLE LINE EXTENSION SECTION 3

BOARD MEETING JUNE 27, 2024

ITEM # 2024-0395



Metro

## HEARING TO ADOPT RESOLUTION OF NECESSITY WESTSIDE PURPLE LINE EXTENSION PROJECT SECTION 3

### **Project:**

The Westside Purple Line Extension Section 3 Project (WPLE3) rail line (subway) that extends from the terminus of WPLE2 in Century City to Veteran's Administration WLA Campus west of the 405 Freeway

### **Property Impacts:**

Permanent Easements (3) and a 67-Temporary Construction Easement (TCE)

### **Property Locations:**

Southwest corner of Wilshire Boulevard and Westwood Boulevard

### **Relocation Impacts:**

Project impacts will not create a displacement

### **Safety Impacts:**

The Board action will not have an impact on LACMTA's safety standards

## HEARING TO ADOPT RESOLUTION OF NECESSITY WESTSIDE PURPLE LINE EXTENSION PROJECT SECTION 3

Assessor's Parcel Number	Project Parcel Number	Parcel Address	Property Owner	Purpose of Acquisition	Property Interest(s) Sought
4324-001-031	W-5004, W-5004-1, W-5004-2 W-5004-4	10900 Wilshire Boulevard, Los Angeles, CA	10900 Wilshire L.L.C., a Delaware limited liability company	Construction and operation the UCLA/Wilshire Station Portal and Plaza	Permanent Easements (3) and a 67-month TCE





- W-5004 – permanent easement for the construction of a station entrance/appendages.
- W-5004-1 - permanent subsurface easement for subsurface entry to the underground station
- W-5004-2 – 67-month temporary construction easement for surface and subsurface construction
- W-5004-4 - permanent easement required to maintain the station entrance, adjacent to the station plaza/entrance

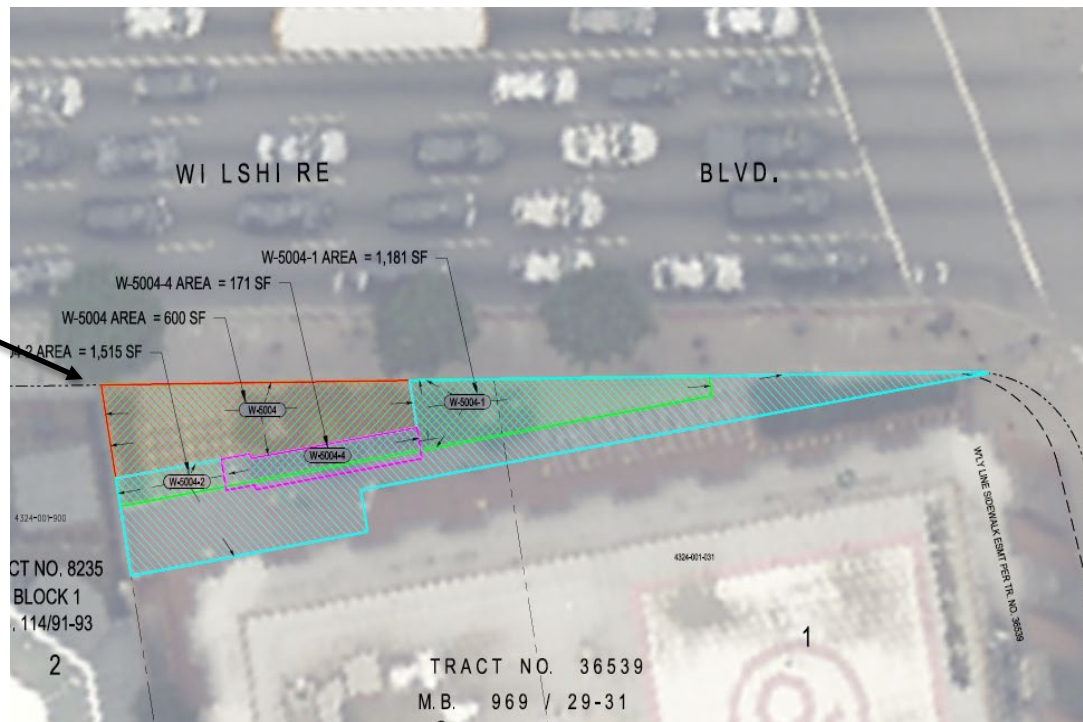

# HEARING TO ADOPT RESOLUTION OF NECESSITY WESTSIDE PURPLE LINE EXTENSION PROJECT SECTION 3



## LEGEND:

-  W-5004 - Permanent Surface Easement - Portal Plaza
-  W-5004-1 - Permanent Subsurface Easement - Station Access
-  W-5004-4 - 67-Month Temporary Construction Easement
-  W-5004-2 - Permanent Maintenance access Easement

## HEARING TO ADOPT RESOLUTION OF NECESSITY WESTSIDE PURPLE LINE EXTENSION PROJECT SECTION 3

**Staff recommends the Board make the below findings and adopt the Resolutions of Necessity:**

- The public interest and necessity require the proposed Project;
- The proposed Project is planned or located in the manner that will be most compatible with the greatest public good and the least private injury;
- The Property sought to be acquired, which has been described herein, is necessary for the proposed Project;
- The offer required by Section 7267.2 of the Government Code has been made to the Owner; and
- The statutory requirements necessary to acquire the property interests by eminent domain have been complied with by LACMTA.





Thank you



Metro®